



May 20th, 2026
File: 002REDST2026

Dear Sir or Madame:

**Re: NOTICE OF PUBLIC HEARING of
Bylaw 22-2017-02-2026
SE 35-53-05 W5M, SW 35-53-05 W5M, NW 35-53-05 W5M, SW 36-53-05 W5M,
NW 36-53-05 W5M and NW 36-53-05 W5M Fr.
Lac Ste. Anne County**

A BYLAW to Redistrict SE 35-53-05 W5M, SW 35-53-05 W5M, NW 35-53-05 W5M, SW 36-53-05 W5M, NW 36-53-05 W5M and NW 36-53-05 W5M Fr. from Agricultural '1' (AG1) District to Aggregate Resource Extraction & Processing (AR) District.

A formal public hearing as required under the provisions of Part 17 of the Municipal Government Act (Sections 216.4, 606, 633, 640, and 692, as applicable) will be held to hear formal presentations on the following proposal:

FIRST, the Lac Ste. Anne County Bylaw 22-2017 is hereby amended in accordance with the attached Bylaw 22-2017-02-2026:

Purpose:

- a. Redistricting the lands legally described and shown on the map identifying the parcels in Schedule "A" from Agricultural '1' (AG1) District to Aggregate Resource Extraction & Processing (AR) District;
- b. amending Map 4 Region D to reflect the redistricting of the lands legally described and shown in Schedule "B" Aggregate Resource Extraction & Processing (AR) District;

First reading was given to Bylaw 22-2017-02-2026 on May 14, 2026. The Public Hearing will address Bylaw 22-2017-02-2026 (Redistricting File 002REDST2026) scheduled below.

Place: Lac Ste. Anne County Office - Council Chambers
56521 Range Road 65

Date: June 11, 2026

Time: 10:00 a.m.

Should you have any comments or concerns regarding this proposed development, please forward them to the undersigned by 4:30 p.m. on June 9, 2026. Alternatively, you can bring your comments and concern up at the Public Hearing Scheduled for June 11, 2026 at 10:00 a.m. at the County Office. To schedule an appointment please contact Senior Development Officer, Tanya Vanderwell at



780.785.3411. Appointment times shall be in accordance with the Procedures (and Committee) Bylaw #12-2025. To attend the meeting via zoom please use the link: <https://us06web.zoom.us/j/81137054983>

The proposed amendment and/or application may be reviewed during regular business hours at the County Office located at 56521 Range Road 65 or on the County website at www.LSAC.ca.

Yours truly,

A handwritten signature in blue ink, appearing to read "Tanya Vanderwell".

Tanya Vanderwell, Senior Development Officer
Planning & Development Department
Lac Ste. Anne County
devassistant@LSAC.ca



SE 35-53-05 W5M
SW 35-53-05 W5M
NW 35-53-05 W5M
SW 36-53-05 W5M
NW 36-53-05 W5M
NW 36-53-05 W5M Fr.

Redistricting the lands legally from Agricultural '1' (AG1) District to Aggregate Resource Extraction & Processing (AR) District

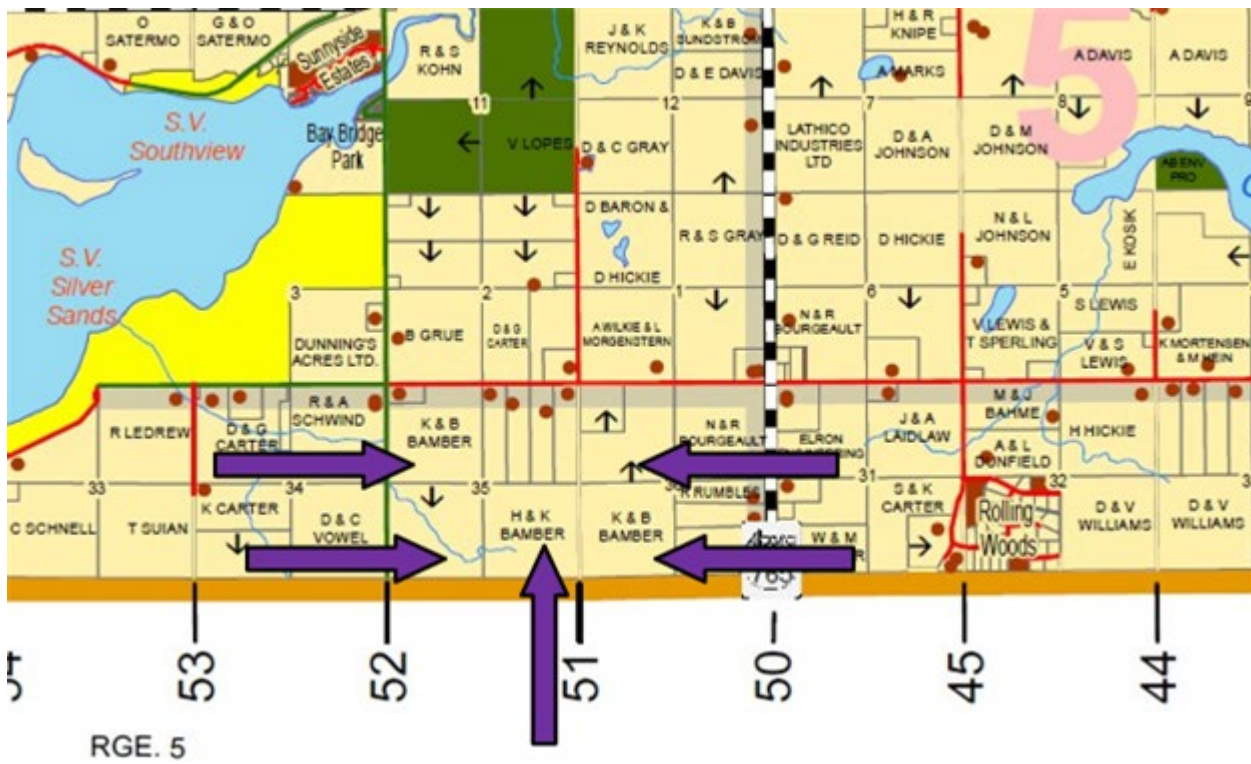



Amending Map 4 Region D to reflect the redistricting of the lands legally described and shown in Schedule "B" Aggregate Resource Extraction & Processing (AR) District

