

LAC STE. ANNE COUNTY MAP 2021



DIV.	HAMLETS	LEGAL LAND DESCRIPTION	MAIN ACCESS	DIV.	FIRE DEPARTMENTS	LEGAL LAND DESCRIPTION	ACCESS	DIV.	SUBDIVISIONS	LEGAL LAND DESCRIPTION	MAIN ACCESS	DIV.	SUBDIVISIONS	LEGAL LAND DESCRIPTION	MAIN ACCESS								
4	CHERRILL	SE 9-56-5-W5 NE 13-54-5-W5	56102 RGE RD 53	5	ALBERTA BEACH	SE 22-54-3-W5	WITHIN ALBERTA BEACH	1	ARDEA PARK	NW 16-55-1-W5	55219 RGE RD 14	5	LAKEHORE COVE	RL 16-54-3-W5	3401 STE. ANNE TRAIL								
4	DARWELL	56594 WOODCO RD 9124 HWY 18	INDIVIDUALLY ADDRESSED	1	EAST STATION	NE 28-54-2-W5	2317 TWP RD 545	2	ASPER HILLS	NW 8-55-1-W5	1414 HWY 37	5	LAKEVIEW PLACE	SE 22-54-3-W5	55022 STE. ANNE TRAIL								
3	GLENVIEW	SE 25-54-4-W5 SW 14-58-9-W5	56022 HWY 33	1	ONOWAY	SW 35-54-2-W5	WITHIN ONOWAY	1	BILBY COMMON	SE 30-54-1-W5	54406 RGE RD 15	1	LAKEWOOD ESTATES	SE 33-53-3-W5	53510 HWY 43								
3	GREENCOURT	SW 11-55-10 & NW 2-55-3-W5	56227 HWY 33	2	STATION 3 (RICH VALLEY)	SE 22-56-3-W5	16 56227 HWY 33	2	BILBY HEIGHTS	NE 28-54-2-W5	54418 RGE RD 14	1	LAURENTIAN ESTATES	SE 5-54-2-W5	2406 TWP RD 540								
3	GUNN	NE 11-56-3-W5 SE 22-56-3-W5	56227 HWY 33	3	STATION 4 (SANGUDO)	NE 36-56-7-W5	5024 ST SANGUDO	2	BIRDWOOD ESTATES	NE 7-54-1-W5	55108 RGE RD 15	4	LESSARD ESTATES	SW 26-56-1-W5	5124 TWP RD 554								
7	RICH VALLEY	SW 17-54-4-W5 NE 7-57-7-W5	56227 HWY 33	4	STATION 5 (DARWELL)	NW 17-54-4-W5	4627 HWY 63	3	BRIDLEWOOD MEWS	SE 22-54-1-W5	54219 RGE RD 15	2	LESSARD LANDING	NE 34-55-5-W5	55530 RGE RD 52								
7	ROCHFORD BRIDGE	SW 35-56-3-W5 & SE 1-57-7-W5	56227 HWY 33	6	STATION 6 (MAYERTHORPE)	NE 21-57-8-W5	WITHIN MAYERTHORPE	3	CHERRYOT HILLS	NE 16-55-1-W5	55220 RGE RD 13	2	LOUISE GLADE	SW 36-56-3-W5	5120 TWP RD 565								
7	SANGUDO	SE 31-56-6-W5	56504 RGE RD 65	4	STATION 7 (CHERRILL)	SW 9-56-5-W5	405 56102 RGE RD 53	1	CHRYSTINA BEACH	SW 17-54-2-W5	54207 RGE RD 25	5	OLDFEN PARK	SE 31-54-1-W5	54127 RGE RD 30								
DIV. LANDFILLS & TRANSFER STATIONS																							
3	HIGHWAY 43 EAST WASTE COMMISSION REGIONAL LANDFILL	NE 18-55-3-W5	55228 RGE RD 35	DIV. COMMUNITY CENTRES																			
4	CHERRILL (Transfer)	NE 4-56-5-W5	56021 RGE RD 53A	2	CAMP NAKAMUN	NE 34-56-2-W5	2201 TWP RD 570	DIV. OTHER															
5	DARWELL (Transfer)	NW 17-54-4-W5	4627 HWY 63	4	CHERRILL COMMUNITY HALL	SE 9-56-5-W5	502 56102 RGE RD 53	3	FERN VALLEY (Mobile Home Park)	SW 20-55-3-W5	55310 RGE RD 14	4	LAKESIDE ESTATES	NE 2-55-5-W5	55022 STE. ANNE TRAIL								
6	MAYERTHORPE (Transfer)	NW 6-54-2-W5	54025 RGE RD 30	3	COYTE COMMUNITY HALL	NE 8-57-5-W5	5404 TWP RD 571	4	GEORGE PEGG GARDEN	SW 8-56-4-W5	56014 RGE RD 43	5	LAKEVIEW PLACE	SE 22-54-3-W5	55022 STE. ANNE TRAIL								
2	ONOWAY (Transfer)	SE 23-57-9-W5	57308 RGE RD 91	6	DARWELL COMMUNITY HALL	NW 18-54-4-W5	54252A HWY 765	5	HANSEN & MOYER BEACH	NW 2-55-5-W5	55022 STE. ANNE TRAIL	6	LESSARD ESTATES	SW 26-56-1-W5	5124 TWP RD 554								
3	RICH VALLEY (Transfer)	NW 11-55-2-W5	55117 HWY 777	6	DEER LODGE COMMUNITY HALL	SE 17-56-8-W5	8410 TWP RD 562	6	KILLDEER BEACH	SE 13-57-3-W5	3010 TWP RD 572	7	LUKE ARNAULT	SW 31-54-5-W5	55119 TWP RD 550								
3	RICH VALLEY (Transfer)	SW 35-56-3-W5	56503 HWY 33	3	GREENCOURT COMMUNITY HALL	SW 14-58-9-W5	608 9124 HWY 18	7	LAC STE. ANNE PILGRIMAGE SITE	RL 8-54-3-W5	300 3510 STE. ANNE TRAIL	8	LAKE MANALI	NW 20-56-3-W5	INDIVIDUALLY ADDRESSED								
3	RICH VALLEY (Transfer)	SW 35-56-3-W5	56503 HWY 33	6	GUNN COMMUNITY HALL	NW 2-55-3-W5	110 55021 STE. ANNE TR	8	LAKE ARNAULT	NW 31-54-5-W5	55119 TWP RD 550	9	LESSARD LAKE CAMPGROUND	NE & SE 26-55-5-W5	55416 RGE RD 51								
3	RICH VALLEY (Transfer)	SW 35-56-3-W5	56503 HWY 33	4	HEATHERIDGE HALL	SW 13-58-8-W5	8018 HWY 18	9	LAKE MANALI	NW 31-54-5-W5	55119 TWP RD 550	10	LUKE ARNAULT	NW 20-56-3-W5	INDIVIDUALLY ADDRESSED								
3	RICH VALLEY (Transfer)	SW 35-56-3-W5	56503 HWY 33	4	LAKE ISLE HALL	SW 8-54-5-W5	5432 HWY 633	10	LESSARD LAKE CAMPGROUND	NE & SE 26-55-5-W5	55416 RGE RD 51	11	LUKE ARNAULT	NW 31-54-5-W5	55119 TWP RD 550								
3	RICH VALLEY (Transfer)	SW 35-56-3-W5	56503 HWY 33	7	RICH VALLEY AGRIPLEX	SE 15-56-3-W5	56216 HWY 33	11	LUKE ARNAULT	NW 31-54-5-W5	55119 TWP RD 550	12	LUKE ARNAULT	NW 31-54-5-W5	55119 TWP RD 550								
3	RICH VALLEY (Transfer)	SW 35-56-3-W5	56503 HWY 33	3	RICH VALLEY COMMUNITY HALL	SE 22-56-3-W5	12 56227 HWY 33	12	LUKE ARNAULT	NW 31-54-5-W5	55119 TWP RD 550	13	LUKE ARNAULT	NW 31-54-5-W5	55119 TWP RD 550								
3	RICH VALLEY (Transfer)	SW 35-56-3-W5	56503 HWY 33	7	ROMEO PEAVINE HALL	SW 31-58-6-W5	6517 TWP RD 590	13	LUKE ARNAULT	NW 31-54-5-W5	55119 TWP RD 550	14	LUKE ARNAULT	NW 31-54-5-W5	55119 TWP RD 550								
3	RICH VALLEY (Transfer)	SW 35-56-3-W5	56503 HWY 33	4	STANGER COMMUNITY HALL	NW 22-55-6-W5	6231 TWP RD 554	14	LUKE ARNAULT	NW 31-54-5-W5	55119 TWP RD 550	15	LUKE ARNAULT	NW 31-54-5-W5	55119 TWP RD 550								
3	RICH VALLEY (Transfer)	SW 35-56-3-W5	56503 HWY 33	2	STETTIN NAKAMUN HALL	SW 18-56-1-W5	1518 TWP RD 562	15	LUKE ARNAULT	NW 31-54-5-W5	55119 TWP RD 550	16	LUKE ARNAULT	NW 31-54-5-W5	55119 TWP RD 550								
DIV. NAMED ROADS LOCATION																							
4	TRAIL OF 1898	From Alexis Reserve & NW 6-54-4-W5M northwesterly through Sections 1, 12, 11, 15, 21 to Twp Rd 554																					
5	LAKE ISLE RD	From Twp Rd 544 & Rge Rd 55 northwesterly through Sec. 19, 30, Twp 54-S, then Sec. 25, 36 to Twp Rd 550																					
3 & 5	STE. ANNE TR	From Jct. Twp Rd 544 west of Rge Rd 30, southwesterly to the east boundary of the Village of Alberta Beach From Gunn Jct., Hwy 43, south along the lake through Sunset Point, Alberta Beach, Val Quentin, then west to Nikoodi Rd (Rge Rd 41)																					
6 & 7	ROCHFORD TR	No direct access off Hwy 43 at Rge Rd 75. From east boundary of Mayerthorpe, southeasterly past Rochfort Bridge to Rge Rd 75																					
1 & 5	RABBIT TR	From Jct. Twp Rd 544 west of Rge Rd 30, northeasterly to the west boundary of Valhalla Acres																					
1 & 5	GREENCOURT RD	From Jct. Hwy 22 & Twp Rd 575, northwesterly to Hwy 18 just east of Greencourt																					
5	RAIL GRADE RD	From Hwy 633, east of Rge Rd 35, to Village of Alberta Beach boundary																					
3 & 5	NIKOODI RD	From Hwy 43 Jct. south on Rge Rd 42A to Jct. Hwy 633																					
3	OLD BARRHEAD HWY	Diagonally from SE to NW 22-57-3-W5M																					
1	HEATHERDOWN RD	From Hwy 43 Jct. east on Twp Rd 540																					
6	JALINA RD	From Hwy 22 Jct. east on Twp Rd 560																					
3	LAC LA NONNE RD	From Hwy 33 Jct. east on Twp Rd 570																					
4	LISBURN RD	From Hwy 43 Jct. south on Rge Rd 62																					
4	PADSTOWN RD	From Jct. Hwy 22 east on Twp Rd 564																					

LAC STE. ANNE COUNTY
 56521 Range Road 65
 Box 219, Sangudo, Alberta T0E 2A0
 T 780.785.3411 TF 1.866.880.5722 F 780.785.2359
 LSAC@SAC.ca www.LSAC.ca

HOW RURAL ADDRESSING WORKS
EXAMPLE: The Rural Address to the right in red illustrates how emergency personnel would know that the access is on Range Road 12, on the east side, approximately 75 metres (150 divided by 2) north of Township Road 542.

542 15 RGE RD 12
 542 15 RGE RD 12
 DENOTES ACCESS OFF RANGE ROAD 12

GENERAL RULES AND GUIDELINES
 • System is ACCESS based
 • Numbers increase going north and west
 • Odd numbers are on the south and east of roads
 • Even numbers are on the north and west of roads
 • There are 32 possible addresses per mile: 16 per side at 100 metre intervals
 • Reference Road is the Township Road to the south or Range Road to the east
 • If two accesses fall within the same interval OR two (or more) residences share one access, one (or more) will be given a letter designation, whichever is to the north and/or west. See the following examples:
 54313 and 54313A RGE RD 12
 1111 TWP RD 544 and 1111A TWP RD 544

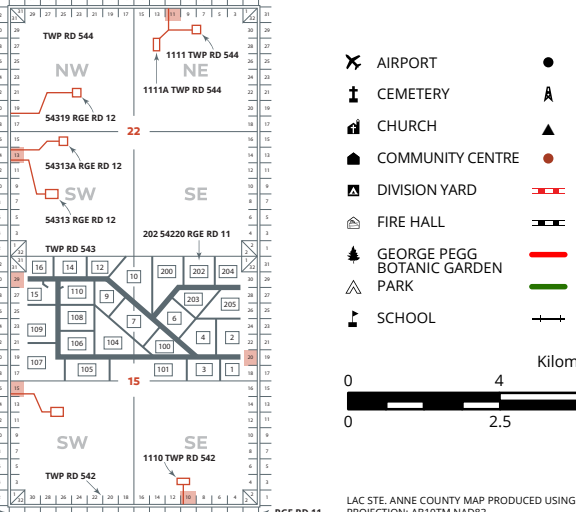
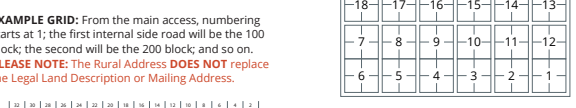

EXAMPLE GRID: From the main access, numbering starts at 1; the first internal side road will be the 100 block; the second will be the 200 block; and so on.
PLEASE NOTE: The Rural Address DOES NOT replace the Legal Land Description or Mailing Address.

GENERAL RULES AND GUIDELINES
 • System is ACCESS based
 • Numbers increase going north and west
 • Odd numbers are on the south and east of roads
 • Even numbers are on the north and west of roads
 • There are 32 possible addresses per mile: 16 per side at 100 metre intervals
 • Reference Road is the Township Road to the south or Range Road to the east
 • If two accesses fall within the same interval OR two (or more) residences share one access, one (or more) will be given a letter designation, whichever is to the north and/or west. See the following examples:
 54313 and 54313A RGE RD 12
 1111 TWP RD 544 and 1111A TWP RD 544

In subdivisions, usually only one number will be assigned as the lots are much smaller. In subdivisions and hamlets, addresses are referenced from where an internal subdivision road accesses a County road. In cases of more than one access, one will be chosen as the main access using the rule of precedence:

EAST-SOUTH-WEST-NORTH
 Lots are numbered clockwise if possible. In the case of multiple blocks with duplicated lot numbers, the legal lot number and rural address number will likely not be the same.

Using the example subdivision on the grid, the main access is to the east. Therefore the rural address is:
 54200 RGE RD 11
 A lot in the subdivision is:
 202, 54200 RGE RD 11
 The second access to the west is:
 2ND ACCESS TO 54200 RGE RD 11

- AIRPORT
- CEMETERY
- CHURCH
- COMMUNITY CENTRE
- DIVISION YARD
- FIRE HALL
- GEORGE PEGG BOTANIC GARDEN
- SCHOOL
- SEWAGE LAGOON
- COUNTY TOWERS
- TRANSFER STATION
- DWELLINGS
- PRIMARY HWY
- SECONDARY HWY
- GRAVEL ROAD
- HARD SURFACE ROAD
- RAILROAD
- STREAMS
- LAKES
- ALEXIS NAKOTA SIOUX NATION CROWN LAND
- COUNTY LAND
- PRIVATE LAND
- TOWNS & VILLAGES
- ELECTORAL DIVISIONS

