

**LAC STE. ANNE COUNTY
PROVINCE OF ALBERTA
BYLAW NO 14-2022**

BEING A BYLAW OF LAC STE. ANNE COUNTY, IN THE PROVINCE OF ALBERTA GOVERNING THE PROVISION OF WASTEWATER LAGOONS AND REGULATING THE LEVYING AND COLLECTING OF FEES AND CHARGES FOR SEWAGE FEES IN CAMPGROUNDS, HAMLETS EXCLUDING SANGUDO AND ALONG THE NORTH 43 LAGOON SEWER LINE.

WHEREAS, the Municipal Government Act, R.S.A. 2000, provides that a Council may pass bylaws governing the supply of wastewater disposal facilities and the levying and collecting of fees and charges related thereto.

WHEREAS, Lac Ste. Anne County deems it necessary to establish rates to support the operation and Capital sustainability of these public utilities

And Whereas the Council of Lac Ste. Anne County deems it necessary to regulate the supply of wastewater disposal facilities for the private and public campgrounds within Lac Ste. Anne County that are not connected to a sanitary sewer system, and to establish applicable rates thereto.

NOW THEREFORE, the Council of Lac Ste. Anne County, duly assembled, enacts the following:

1. This Bylaw shall be known as the Lac Ste. Anne County Wastewater Utility Rate Bylaw.
2. All properties in the area outlined in Schedule “A” shall be deemed to be part of the utilities and subject to the utility rates established in Schedule “B”
3. All properties not outlined in Schedule “A” or that are not connected to a Utility as outlined in the Sewer Utility Bylaw shall be subject to the utility rates established in Schedule “C” and/or the Sangudo Utility Bylaw
4. That the fees collected shall be used solely for the support of the municipal public utility system which the fees are established.
5. That words used in this Bylaw shall have the same meaning as words used or defined in the Municipal Government Act.
6. That all accounts shall be due and payable when rendered, with payment to be made at the Lac Ste. Anne County office. Failure to receive an invoice shall in no way affect the liability of the consumer to pay the account.
7. That should the campground owner choose to provide payment once per year, and upon mutual agreement with Lac Ste. Anne County, that the payment may be made annually, prior to August 31st with no monthly interest accruing.
8. Penalties on overdue wastewater disposal accounts will be calculated at 3.5% per month on the full balance outstanding. After an account has been outstanding for 3 (three) months the outstanding balance will be added to the property tax roll.
9. Therefore the following Bylaw is rescinded:
 - a) 34-2021 Wastewater Utility Rate Bylaw

FIRST READING this 12th day of May 2022.

SECOND READING this 12th day of May 2022.

READ A THIRD AND FINAL TIME THIS 12th day of May 2022.

Enactment

10. This Bylaw shall come into force and effect on May 12th, 2022

Reeve _____
County Manager _____
(Seal)

The image shows a handwritten signature in blue ink over a horizontal line. To the right of the signature is a circular official seal with a scalloped edge. The seal contains the text "COUNTY OF" at the top and "2011" at the bottom. The word "Seal" is printed in black text to the right of the signature.

BYLAW NO 14-2022

SCHEDULE A: Major Utility Systems

Lac Ste. Anne



November 9, 2017

1:36,112

- | | |
|-------------------------|--------------------------------|
| • Rural Address | ● ssFitting |
| Land Parcels | ● Sewer Shutoff |
| ● Proposed Overpass | — Sewer Laterals |
| — Proposed Service Road | — Sewer Mains |
| ● Manhole | □ Forced Main Development Zone |

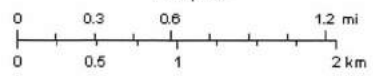

LSACG Department

Development App
LSACG Department

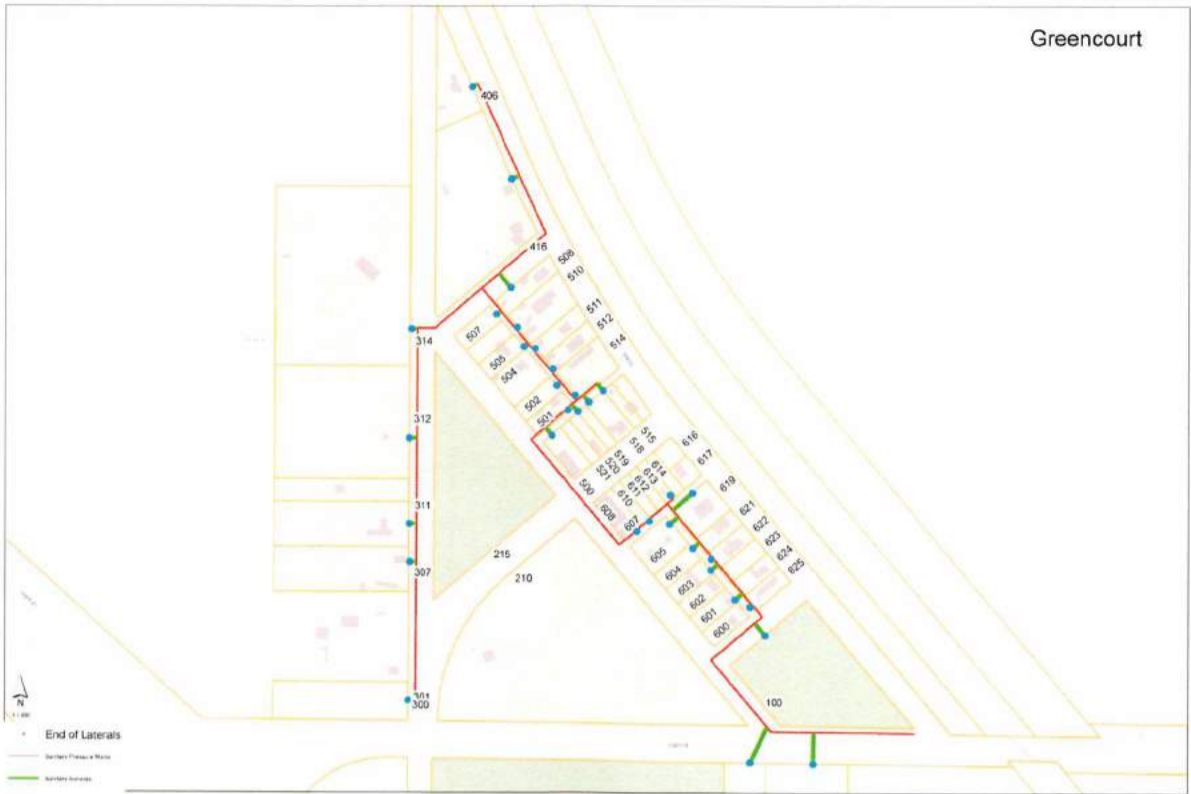

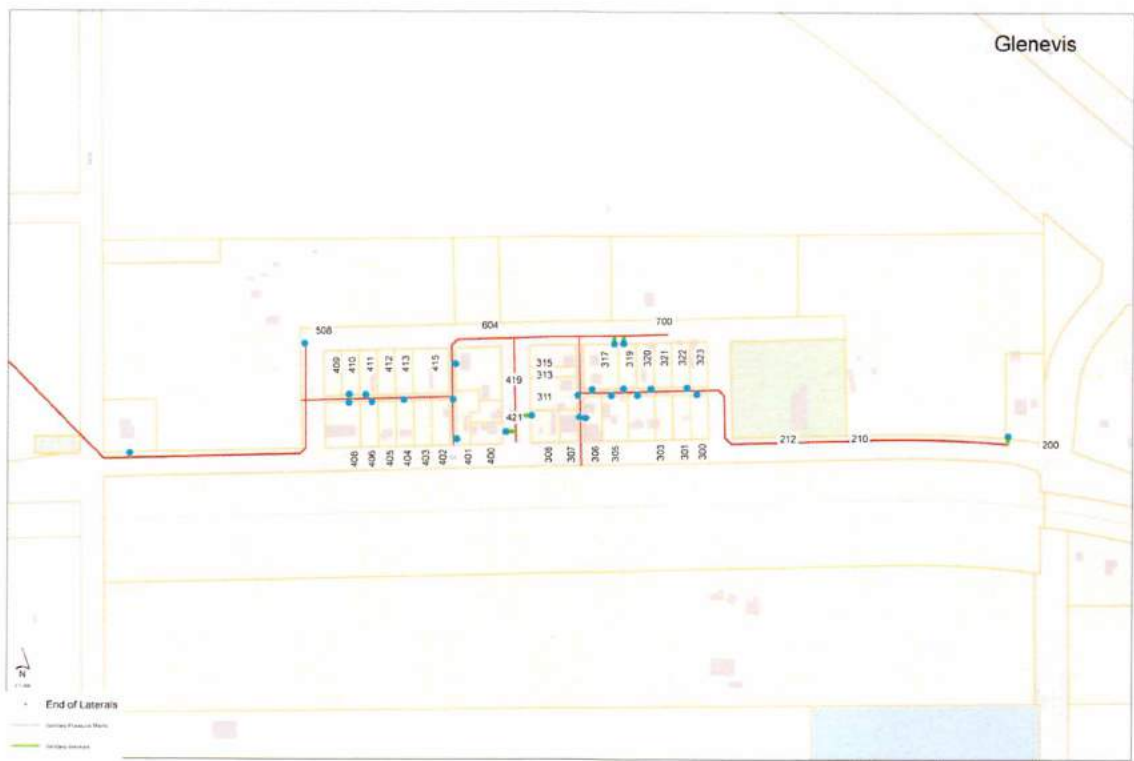

Cherhill



Schedule B: Monthly Rates and Charges of Major Utility Systems

1. North 43 Lagoon System:

*Note depending on the use and facilities on your property you will be charged a combination of the fees below. (For example, if you have a gas station with a public washroom your fee would be \$70.12 a month)	
	Sewage Services
PROPERTY TYPE OR LOCATION	Monthly Fixed Charge
Hauled Sewage Dumping Fee deposited directly at the Lagoon	\$65.00 per legal load
Residential Use	\$23.06 per unit
Institutional Uses	\$6.15 per bed \$23.06 per public washroom \$53.72 per kitchen facility not included in a housing unit
Veterinary Clinics	\$66.87 \$23.06 per public washroom
Commercial/Recreational Uses	
Manager Suites	\$23.06 per unit
Commercial Recreation	\$2.77 per camp site \$23.06 per public washroom \$53.72 per kitchen facility not included in a housing unit \$6.15 per hotel room (no kitchenette)
Gas Stations	\$47.06
Restaurants	\$46.12
Car Washes	\$23.06
Miscellaneous Types	
Public Washrooms	\$23.06

2. Hamlet of Greencourt: \$10.96 per month
3. Hamlet of Rochfort Bridge: \$10.96 per month
4. Hamlet of Darwell: \$10.96 per month
5. Hamlet of Glenevis: \$10.96 per month
6. Hamlet of Cherhill: \$10.96 per month

Schedule C- User Fees for non-connected utility Users

Recreational Properties	
a. Per RV Stall	\$6.00 per RV lot per month of operation